

145.0 mm

2022-12-10-HomeElectric-T-614-说明书

210.0 mm

HomeElectric
Chopper Instruction Manual
T-614



SAFETY PRECAUTION

- When using electrical appliances, basic safety precaution must always be followed:
- Carefully read all instructions before operating and save for future reference.
 - This appliance is intended to be used in household and similar applications such as:
 - staff kitchen areas in shops, offices and other working environments;
 - farm houses;
 - by clients in hotels, motels and other residential type environments;
 - bed and breakfast type environments.
 - Always disconnect the appliance from the supply if it is left unattended and before assembling, disassembling or cleaning.
 - This appliance shall not be used by children. Keep the appliance and its cord out of reach of children.
 - This appliance can be used by children aged from 8 years and above and persons with reduced physical, sensory or mental capabilities or lack of experience and knowledge if they have been given supervision or instruction concerning use of the appliance in a safe way and understand the hazards involved.
 - Children shall not play with the appliance. Cleaning and user maintenance shall not be made by children without supervision.
 - If the supply cord is damaged, it must be replaced before further use by the manufacturer, its service agent or similarly qualified persons in order to avoid a hazard.
 - Switch off and disconnect the appliance from the supply if it is left unattended and before assembling, disassembling or cleaning.
 - Be careful if hot liquid is poured into the food processor or blender as it can be ejected out of the appliance due to a sudden steaming.
 - Care shall be taken when handling the sharp cutting blades, emptying the bowl and during cleaning.
 - This appliance includes a safety switch which prevents operation unless the accessories are securely installed.
 - To protect against risk of electric shock, fire or personal injury, do not immerse power cord, plug or motor base in water or any form of liquid.
 - Do not immerse Motor Base in water, neither rinse it under tap water.
 - Be extremely careful when handling blades and inserts, especially while assembling and disassembling, and cleaning after use. Blades are very sharp.
 - Do not let power cord hang over the edge of a table or counter, or touch any hot surface.

- Do not place the appliance near a gas outlet, electric burner, or heated oven.
- Please wait till all the blade stop running before unplugging the power cord and taking off the processing bowl.
- Ensure the capacities shown in the Specifications section are not exceeded.
- The appliances are not intended to be operated by means of an external timer or separate remote-control system.

PACKAGE CONTENTS

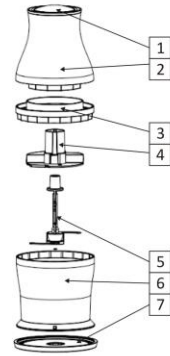

- Turbo button
- Main unit
- Cover
- Protective sheath
- Blade
- Bowl
- Bowl pad

Using product

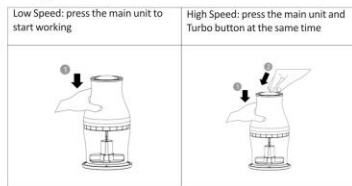

Operation

- Boneless and fatless meat that has been cut into size approximately 20 mm x 20 mm x 60 mm, total weight not exceed 200g
- Operate with high speed setting for 15 seconds

Cleaning & Maintenance

	✗	✗	✓
	✓	✓	✓
	✓	✗	✗

- Means it can cleaning by water
- Means it can cleaning by dish-washing machine
- Means it can only clean by the dry cloth
- If the product operating with abnormal noise, or shaking seriously. Please stop use this product, and send back to the service agent to check it. Never repair the product by yourself.

Storage

- After use the product, please repack the product, and store it in a dry place and avoid sun exposure.
- Make sure the children could not reach the product.
- Keep the product dry before repack.

Technical ratings

Rated voltage: 220 V – 240 V
Rated frequency: 50 Hz / 60 Hz
Rated power: 350 W

ENVIRONMENT FRIENDLY DISPOSAL

You can help protect the environment!
Please remember to respect the local regulations: hand in the non-working electrical equipments to an appropriate waste disposal center.