



HGS-410
USERS'MANUAL

PRODUCT SPECIFICATION

MODEL	HGS-410
input voltage	220-240V
rated power	1555-1850W
max steam rate	36g/min
steam last period	55min
tank capacity	2.0L
steam temperature	90°C

CLEANING AND STORAGE

- We recommend you follow this procedure at least once per week.
1. Turn the switch to "0" position.
 2. Unplug the cord from the power outlet.
 3. Allow the steamer to cool for at least 20 minutes.
 4. Remove the hose and attach the extension tube, then set them aside.
 5. Remove and drain the water tank. Rinse the water tank with clean water, and drain completely. Press the water fill tank back on the water reservoir.
 6. Clean the steamer by removing the clean plug and wiping the contacts.
 7. Flush the unit by filling the water reservoir and the hose connector with fresh water and draining completely.
 8. Store in a cool, dry place.

DIRECTORY

1. IMPORTANT SAFE GUARDS
2. PRODUCT PARTS
3. ASSEMBLY/USE INSTRUCTIONS
4. APPLICABLE PLACE
5. PRODUCT SPECIFICATION
6. CLEANING AND STORAGE
7. TROUBLE SHOOTING

IMPORTANT SAFE GUARDS

1. Please be sure your electricity supply is 220V-240V-50/60Hz.
2. Do not operate another high voltage appliance in the same outlet of extension to avoid overload.
3. Use the appliance only as described in the manual. Other uses not recommended may cause fire or electric shock.
4. Do not remove the cord, power cord or plug in water.
5. Do not leave the steamer unattended while it is in operation.
6. Close supervision is necessary when the appliance is used by or near children.
7. Do not operate the steamer without filling the water reservoir. Always check the water level before and during operation.
8. Do not try to hose on the ground or wind it.
9. Do not touch the hot metal parts, hot water or steam to avoid burns.
10. Move the appliance by grasping the telescopic pole. Do not touch the casters if they are hot. Turn off the Unit, drain the water tank and water reservoir before inspecting the casters.
11. Allow the appliance to cool completely for at least 20 minutes drain the water tank and reservoir before storage.
12. Always disconnect the appliance from the outlet before filling or emptying water. Be careful to avoid scalding water boiling from the water reservoir.
13. Unplug the cord from the outlet when not in use, when moving into from one location to another and before cleaning.
14. Do not place the unit or any parts near an open flame, cooking or other heating appliance.
15. Do not place the unit with a damaged cord, plug, after a malfunction or if damaged or damaged wire any manner.
16. If disconnected, plug the plug and pin it from the wall outlet. Never plug the cord.
17. Do not use extension cords to avoid overheating and risk of fire.
18. No detergent can be added into the water tank or it will cause damage. Distilled or de-ionized water is recommended.

C. How to iron clothes

1. The high temperature steam can soften the garment fibers. It's very difficult to iron the garment smoothly if only depends on the steam which the nozzle emits. The clothes hang on the clothes hanger and pull the bottom of the garment to the top of the garment. The top part of garment deformation is fixed and pull the bottom of garment with the hand, make the garment surface as smooth as possible.
 2. Close steam. The steam nozzle on the garment, across the nozzle gently. Move from the middle to the bottom to the top of the garment. Push the bottom four and pull the top to high temperature steam.
 3. Check and tighten the top of garment when steaming the bottom. Steep a side to make vertically, from the bottom to top of the garment. Be careful! Do not steam from steam nozzle.
 4. Press downward for a longer time on the garment collar hanging with outside when steaming. Steam 3 back and forth from the bottom to the top.
 5. To tighten the garment collar when steaming, press for a longer time on the collar hanging with inside. Steam 3 back and forth from the bottom to the top.
 6. Check the back of garment after ironing the front.
- D. How to use the brush or trousers clip**
1. When you want to iron the clothes using the steamer with brush clip assembly the brush is on the
 2. When you want to iron the clothes using the steamer with trousers clip assembly the trousers clip is below

APPLICABLE PLACE

Home - clothes shop, hotel and washing shop.

PROBLEM	REASON	SOLUTION
Doesn't iron	Doesn't use steam	Plug into electrical outlet
Doesn't iron properly	Doesn't use steam properly	Check the steam nozzle
Doesn't iron smoothly	Doesn't use steam properly	Check the steam nozzle
Doesn't iron quickly	Doesn't use steam properly	Check the steam nozzle
Doesn't iron evenly	Doesn't use steam properly	Check the steam nozzle
Doesn't iron completely	Doesn't use steam properly	Check the steam nozzle
Doesn't iron thoroughly	Doesn't use steam properly	Check the steam nozzle
Doesn't iron completely	Doesn't use steam properly	Check the steam nozzle
Doesn't iron thoroughly	Doesn't use steam properly	Check the steam nozzle
Doesn't iron completely	Doesn't use steam properly	Check the steam nozzle
Doesn't iron thoroughly	Doesn't use steam properly	Check the steam nozzle

PRODUCT PARTS

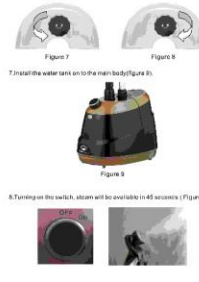

ASSEMBLY/USE INSTRUCTIONS



ASSEMBLY/USE INSTRUCTIONS

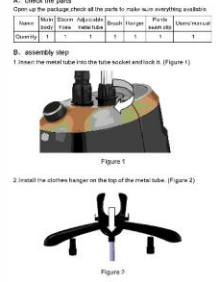

ASSEMBLY/USE INSTRUCTIONS

