

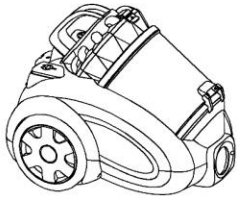

HomeElectric
VACUUM CLEANER
INSTRUCTION MANUAL

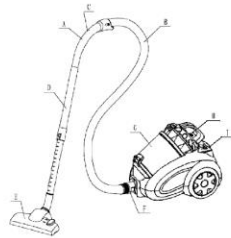

HV-307



DESCRIPTION

- A. Handle
- B. Hose
- C. wind-force adjuster
- D. Tube
- E. Floor brush
- F. Hose connector
- G. Dustbin
- H. Cord rewind button
- I. Power switch

2

IMPORTANT

- Read this instruction booklet carefully.
- Before using the appliance, check that the mains power voltage corresponds to the voltage shown on the rating plate.
- The appliance should be connected to a correctly-earthed 10 power socket.
- Always remove the plug from the power socket when the appliance is not in use and before carrying out any cleaning or maintenance operations.
- Always remove the plug from the power socket before opening the appliance.
- Never use methylated spirits or other solvents to clean the appliance.
- Do not use the appliance to vacuum liquids.
- Never leave the appliance unattended when it is switched on. Keep the appliance out of the reach of children or the infirm.
- This appliances for domestic use only. Use as described in this instruction booklet.
- Do not switch the appliance on if it appears to be faulty in any way.
- For repairs or accessories, contact your dealer or an authorized Service Center.
- If the supply cord is damaged, it must be replaced by the manufacturer or its service agent or a similarly qualified person in order to avoid a hazard.

- Do not remove the plug from by pulling the cable the or appliance itself
- Do not run the appliance over the power cable
- Do not use the appliance to vacuum lighted matches, cigarette ends or hot ash.
- Do not use the appliance on wet surfaces.
- Do not obstruct the air intake or outlet vent.
- Do not use the appliance to vacuum needles, drawing -pins or string.



3

ASSEMBLING THE VACUUM CLEANER

Removing the flexible tube
Remove the plug from the power socket. To release the flexible Tube, press the button on the end of the tube and pull the tube firmly from the air intake duct.



Fitting the extension tubes and accessories

- Fitting the extension tube
- Fitting the extension tubes
- Fitting the accessories to the extension tube



4

INSTRUCTION FOR USE

1. Before using the appliance, unwind length of cable and insert the plug into the power socket. Do not extend the cable beyond the RED mark. To rewind the power cable, press the rewind button with one hand, and guide the other hand to ensure that it does not whip causing damage.
2. Press the ON/OFF button to switch the appliance on.

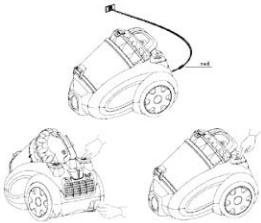

5

Using the cleaning accessories

- Dual-position carpet/floor brush. Pos. 1: bristles extended for hard floors
- Pos. 2: bristles retracted for carpets

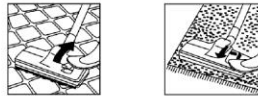

- Narrow nozzle, for cleaning spacers, corners, edges, drawers etc.
- Small brush for cleaning euntings, shelves, books, inside lamps and other delicate objects.



6

Clean the dust

1. Lift the form cover and take out the dust cup.
2. Take out the foam form dust cup.
3. Clean off the dust inside the dust cup.



Clean the foam

1. Take out the foam when it's getting dirty.
2. Clean it in the water, dry it naturally before next use.



7